

LED Gimbal Downlight Installation Instruction

Description

The LED Gimbal Downlight is an energy-efficient LED recessed ceiling fixture that is perfectly suited for mounting in system/hollow ceilings. The fixture provides a pleasant light array with a beam angle of 24°/45°. The fixture comes completely with standard driver(included). It is mounted by using spring clamps connection.

Package contents

- 1 x Downlight 20W/30W/40W
- 1 x Driver with open cable end
- 1 x Manual

Safety Instruction

- Unplug mains before installing or wiring the fixture.
- Never look directly into the light source.
- User must be follow the safety instruction and warning clauses written in this manual.

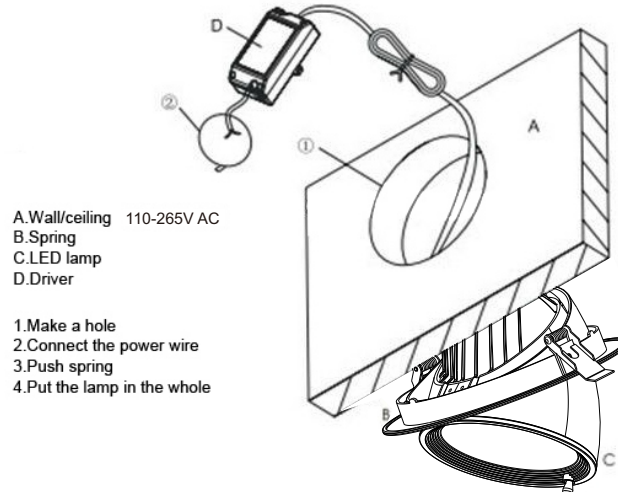

Warning

Electrical products can cause death or injury, or damage to property. This product should be installed by a qualified licensed electrician.

- Ensure mains supply is switched off before commencing work
- Before cutting, ensure that the hole does not impinge on joists, pipe work, cables or other building services

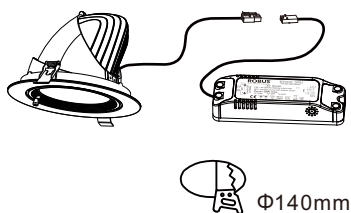

Fig 1. This luminaire requires a round hole
20W Φ140mm, 30W Φ140mm ,
40W Φ170mm to be cut into the ceiling
for correct installation.

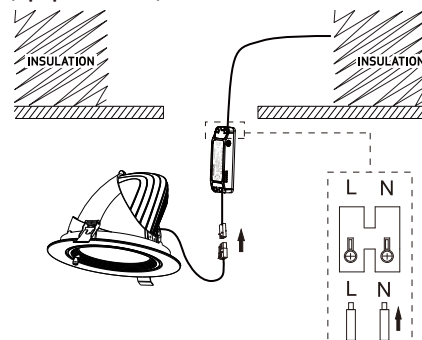

Fig 2. Connect the Driver to AC power supply
110-265V,50/60Hz. Connect luminaire to the
driver by means of the quick fix connector.

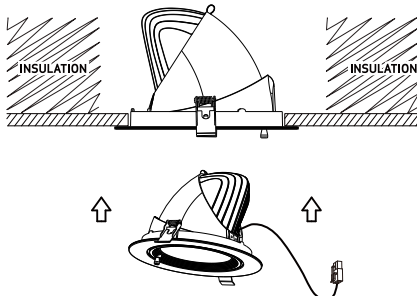

Fig 3. Offer the luminaire and the driver up to
cut-out with the springs being held
vertically.

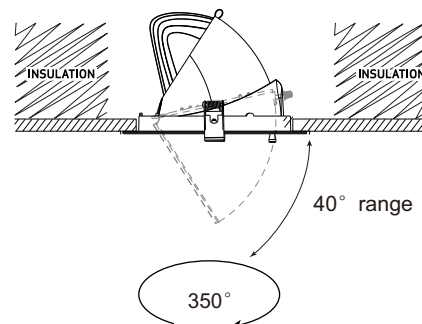

Fig 4. Can be adjust the downlight to the wish
position. Rotates up to 350° and downward
tilt to 40°. (see above diagram)